

HUBstands ProStix™

HUBStands ProStix come as a complete set of four (4) machined STIX (A), each marked for a specific corner of the car. Each machined ProStick has 2 Mounting Stubs (B) and hardware and a pair of Black Measurement Scales (C),



ATTACH the ProSTIX

Bolt the long, studded extension Stub Arms (B) to the Hub Plates on your HUBStands with a pair of the small, black FHS screws; then attach the ProStix (A) to the stubs with the black Knobs.

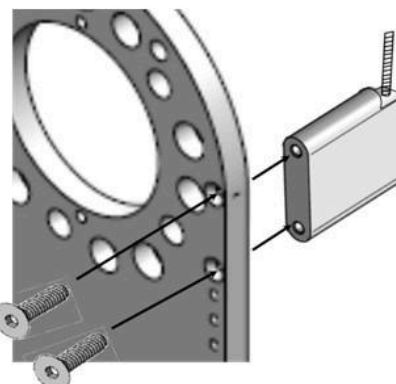

SETTING UP STRINGS

The ProStix can be used to quickly set up and align your string set to the wheel centers. Straighten and lock the wheels. Insert one of the Black Measurement Scales (C) into the CENTER slot on the face of the ProStick, in-line with the center of the hub. Tighten w/ a red thumb screw.

Use the center mounted measurement scale to set up your string line equidistant from the hub centers on each axle pair.



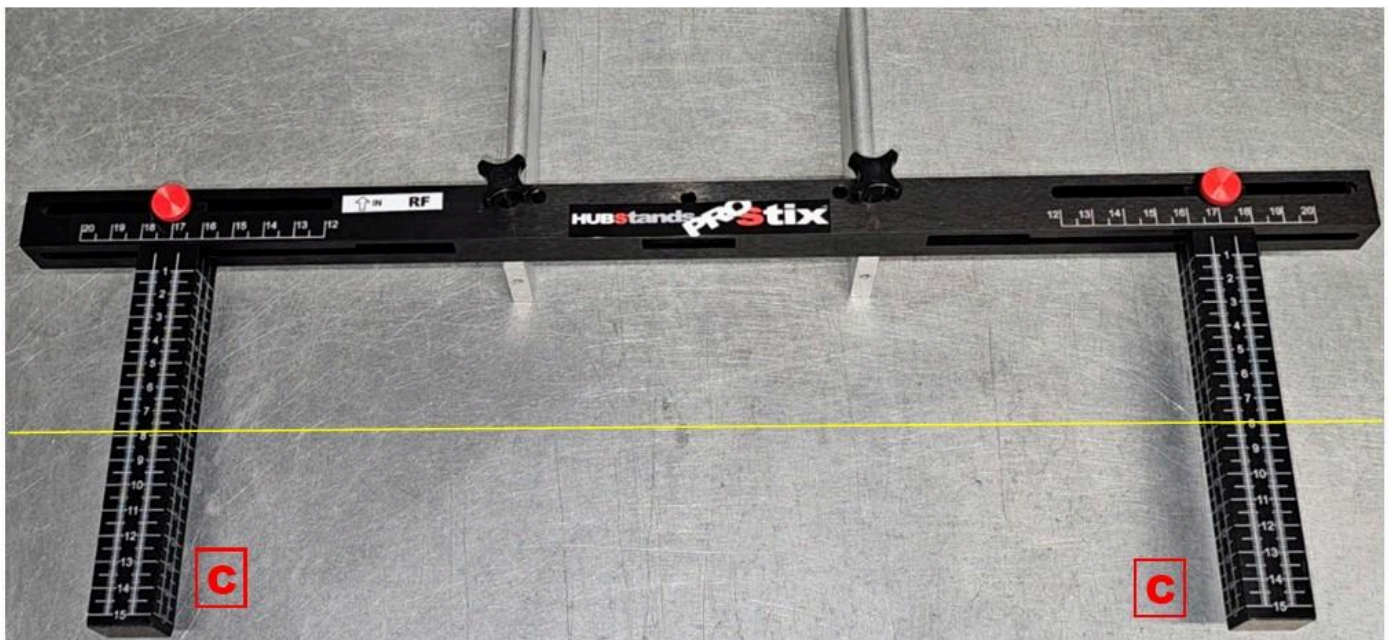

MEASURING TOE

With your String lines now set parallel and equidistant from the hubs, insert and tighten the Black Measurement Scales (C) at the appropriate wheel size. Make sure the measurement scales are held flat against the Stix as you tighten them in place. The string line should just rest on or slightly above the Black Measurement Scales.

With the wheels pointed and locked straight, read the difference between the front and rear Measurement Scale values. The difference is the Toe in/out in mm's for a specific wheel diameter at each corner of the car. With the wheels pointed and locked straight, read the difference between the Front and Rear red measurement scale values. Record the Toe In/Out values for each corner of the car.

The Measurement Scales in the photo below are Red and are of an earlier variant. The current Measurement Scales are Black as shown above.

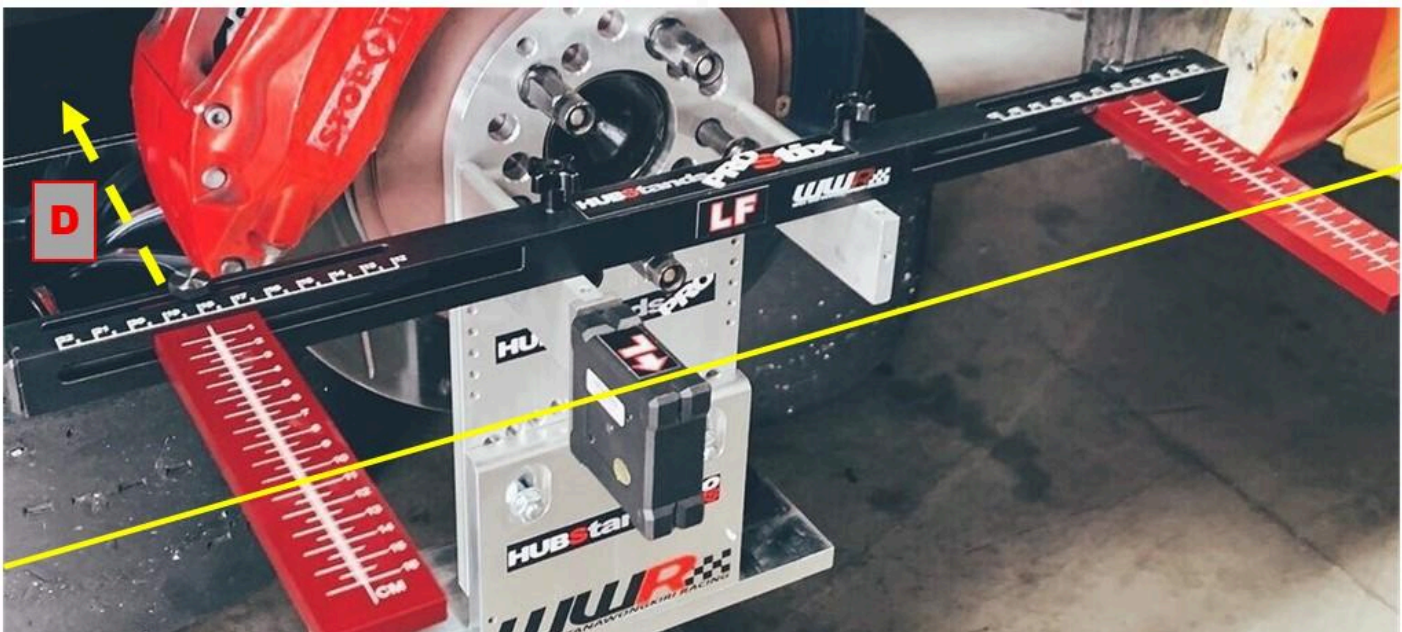

Quick Toe Check, "Back Toe"

After measuring and recording your Toe settings and with the everything still locked and in place, measure your "Back Toe" (D). "Back Toe" is a single measurement of the distance from a point on the back edge of the ProSTIX to a fixed hardpoint on the chassis. As long as the Toe doesn't change this "Back Toe" value won't change and you won't have to set up your strings to confirm your toe settings.

HUBstands

BBXRacing Ltd. 4755 Boncrest Road West Clarence NY 14221
info@bbxracing.com 716 . 632 . 3919